

## Storage & disposal

Store DrugWipe® 5+ at +5 °C to +25 °C.

Do not store the test below 0 °C or above 40 °C.

Do not freeze DrugWipe® 5+.

Dispose of the used and expired tests as normal refuse according to municipal regulations.

## Transportation & in-the-field

Transport DrugWipe® 5+ at +5 °C to +35 °C for a maximum of 3 days.

Protect DrugWipe® 5+ from rain and snow when using it in the field.

Carry out the analysis at +5 °C to +40 °C.

If temperatures are below +5 °C prewarm the sealed foil pack prior analysis, e.g. in your hands or inside the car.

## Quality control

DrugWipe® 5+ contains an integrated control line (CL). The control line (CL) indicates functionality and correct implementation of the test. Consider additional steps for quality control as required in your circumstances.

## Cross reactions

Substances, that show cross reactions with DrugWipe® 5+, have been analysed in our laboratory. Upon request we provide a complete list of substances with cross reactions.

Securetec Detektions-Systeme AG guarantees functional capabilities and characteristics of their products, provided that all test instructions have been considered carefully.

Securetec Detektions-Systeme AG and distributors are not liable for misuse or abuse of this product.

## Ordering information

### DrugWipe® Single tests

Part No.	Test
001-CAN	DrugWipe® Cannabis
002-COC	DrugWipe® Cocaine
003-OPI	DrugWipe® Opiates
004-AMP	DrugWipe® Amphetamines (Ecstasy/Methamphetamines)
005-BEN	DrugWipe® Benzodiazepines
006-MTD	DrugWipe® Methadone

### DrugWipe® TWIN

Part No.	Test
0014-TWIN-C/A	DrugWipe® TWIN Cannabis/Amphetamines
0023-TWIN-C/O	DrugWipe® TWIN Cocaine/Opiates

Part No.	Test
0014N-TWIN-C/A	DrugWipe® TWIN saliva specific test Cannabis/Amphetamines
0023N-TWIN-C/O	DrugWipe® TWIN saliva specific test Cocaine/Opiates

### DrugWipe® 5

Part No.	Test
008-DW-5	DrugWipe® 5 Cannabis, Amphetamines (Ecstasy/ Methamphetamines), Cocain, Opiates
009N-DW-5+	DrugWipe® 5+ saliva specific test Cannabis, Amphetamines (Ecstasy/ Methamphetamines), Cocaine, Opiates

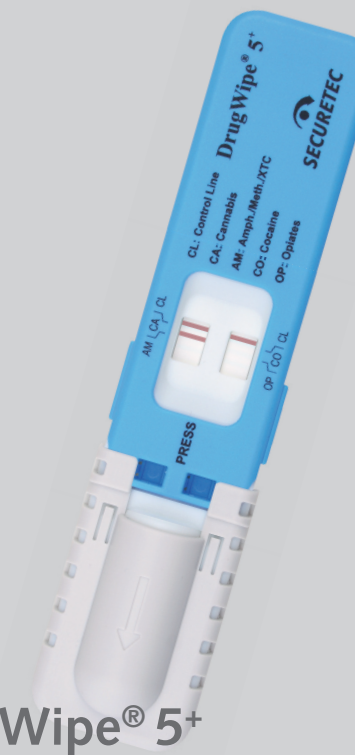

## DrugWipe® 5+ Short instructions

Saliva test for the detection of  
Cannabis  
Opiates  
Cocaine  
Amphetamines/Methamphetamines/Ecstasy

Part No. 009N-DW5+



Securetec Detektions-Systeme AG · Eugen-Sänger-Ring 1 · D-85649 Brunnthal

T +49 89 203080-1651 · F +49 89 203080-1652

info@securetec.net · www.securetec.net

© 2009 Securetec Detektions-Systeme AG · v03-EN-090608

## Intended use

DrugWipe® 5+ detects drugs in saliva. The immunoassay test detects cannabis, opiates, cocaine, amphetamines and methamphetamines (ecstasy). The analysis delivers a visible, qualitative result within 10 minutes. We recommend all positive samples are confirmed with a secondary chemical method, e.g. gas chromatography plus mass spectrometry (GC-MS). DrugWipe® 5+ is for single-use per sample only. The test is intended to be used for in-vitro-diagnosis only.

## Test principle

DrugWipe® 5+ is based on an immunoassay method. Drug consumption can be detected up to 10 hours in saliva. The sampling of the saliva is carried out with a swab on the tongue or from the interior of the cheeks. The sampling pads transfer the saliva onto the test strips. Drug specific, red stained antibodies are applied on the test strips. If any drugs are present in the saliva sample, the drugs will bind onto these antibodies. DrugWipe® 5+ contains an sealed ampoule filled with a liquid. The test is started when the ampoule is crushed and the liquid released. The liquid carries the antibody bound drugs towards the test line. The test line is visibly stained red for a positive result. The test is valid only when both the control lines are also stained red. The test result is read at 10 minutes.

## Content

The test packet contains:

- 1 DrugWipe® 5+ saliva test

Not provided with the test, but required in individual cases:

- 1 timer
- 1 pair of single-use gloves
- 1 torch for interpretation in the dark

## Analysis

1. Check the expiry date on the foil pack. Discard the test after this date.
2. Check the foil pack for damages. If any damage is seen, if moist inside or the control lines are stained red already, discard the test.
3. Only open the foil pack at the cut directly before use.

## Test implementation

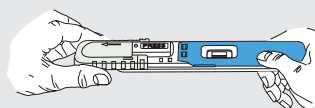
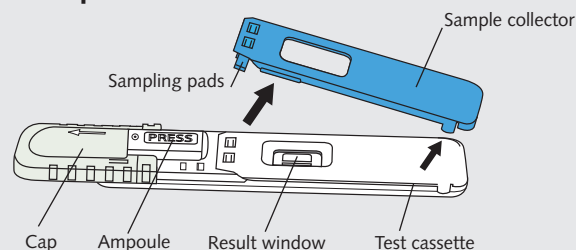

1. Move the cap in the direction of the arrow, until the word PRESS is visible entirely.

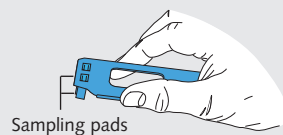

2. Remove the blue sample collector from the white test cassette. Do not touch the sampling pads.

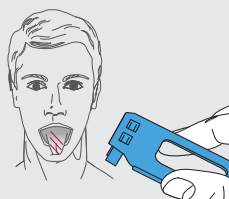

3. Advise the test person to move their tongue around the bottom of the cheek approximately 3 times. With the sample collector wipe the saliva from the tongue or interior cheek with the sampling pads.

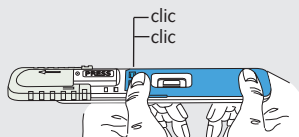

4. Place the blue sample collector back onto the white test cassette and press home. Both sampling pads must lock in with an audible double clic.

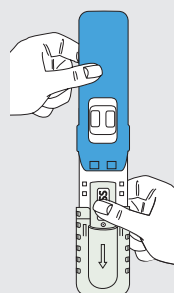

5. Hold the test cassette vertically with the ampoule at the bottom. Squeeze thoroughly on the word PRESS with the thumb until the ampoule breaks. Hold the test cassette with the ampoule vertical for 10 to 15 seconds.

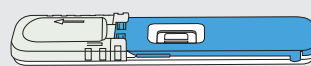

6. Move the cap back into the starting position. Lay the test on a horizontal surface and commence timing. Read the test result at 10 minutes. Ignore test results before and after.

## Test interpretation

Each of the two result windows shows two drug substances and one control line. The abbreviations stand for:

- CA Cannabis (THC/Marijuana/Hashish)
- AM Amphetamines (Ecstasy/Methamphetamines)
- CO Cocaine/Crack
- OP Opiates (Heroin/Morphine)
- CL Control line

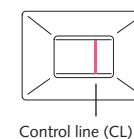

### Negative result = No drug consumption

The test is valid when both control lines (CL), one on each strip, turn red. The test is negative for drugs when no other red test lines appear.

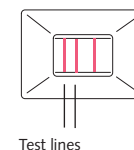

### Positive result = Drug consumption

The test is valid when both control lines (CL), one on each strip, turn red. The test is positive for a drug, when one or more red test lines appear.

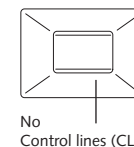

### Invalid result

The test is invalid when either one or both the control lines (CL) do not turn red. Repeat the analysis using a new DrugWipe® 5+ test.

**Notes:** The test is also positive, when the test lines are stained faintly or only partially red. In the case of highly positive samples, you may observe visible test lines within three minutes. However wait the full ten minutes of test development and then read all the test lines. Test lines stained visibly after the lapse of ten minutes are invalid and should be ignored.

## Precautions

- Read the test under sufficient light, e.g. interior light of the car or torch.
- Treat each sample as potentially infectious. During analysis wear single-use gloves.
- Note, red-green colour blindness may have an effect on correct test interpretation.
- Do not use DrugWipe® 5+ for persons allergic to polyester.